

EXISTING

- ① RHODE ISLAND AVE. METRO STATION
- ② PEDESTRIAN BRIDGE
- ③ STAIR-RAMP CONNECTION
- ④ METROPOLITAN BRANCH TRAIL

PROPOSED

- ⑤ RE-ALIGNED METROPOLITAN BRANCH TRAIL
- ⑥ PEDESTRIAN PLAZA
- ⑦ LANDING AND GRAND STAIR
- ⑧ RELOCATED PUBLIC ART
- ⑨ CYCLE LANE CONNECTION
- ⑩ FLEXIBLE OPEN SPACE



View of Stair to Edgewood Apartments

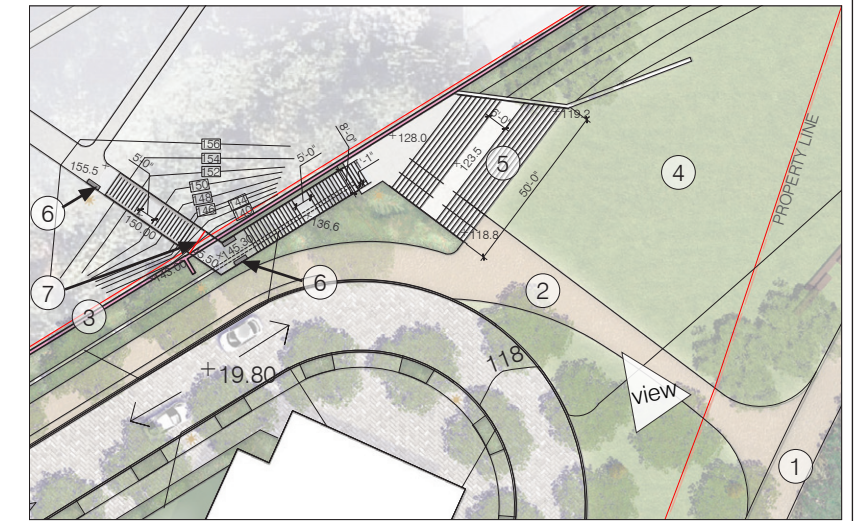

Plan Enlargement

- ① METROPOLITAN BRANCH TRAIL
- ② CYCLE LANES
- ③ EXISTING ART WALL
- ④ FLEXIBLE OPEN SPACE
- ⑤ GRAND STAIR
- ⑥ BUILT IN SEATING
- ⑦ GATE
- ⑧ ACCESS STAIR
(SUBJECT TO APPROVAL BY
ADJACENT PROPERTY OWNER)



Precedent images of Access Stair



Bike Tire Trough

Note: Images identified here are not exact representations of proposed site elements. These images are shown to provide general character of site features. All Murals are to be planned and executed by an artist and the images shown are for illustrative purposes only.

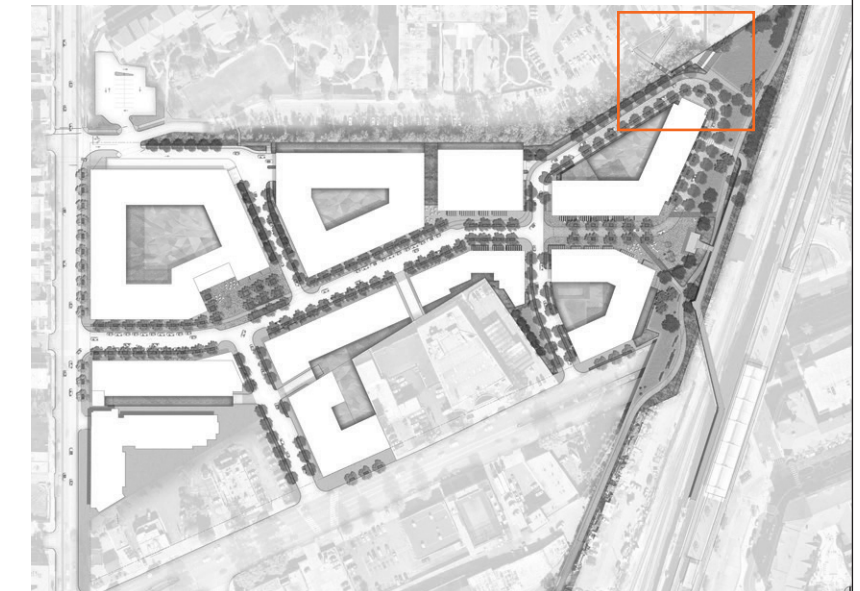

KEY PLAN



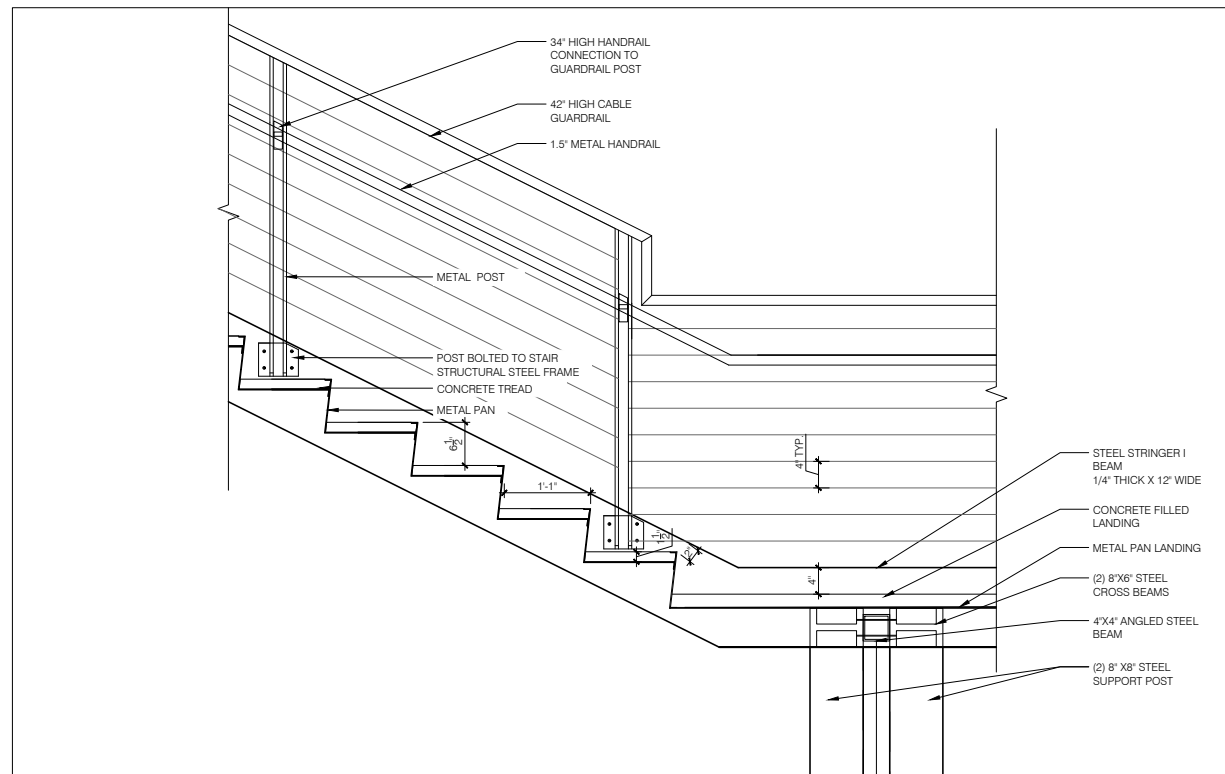
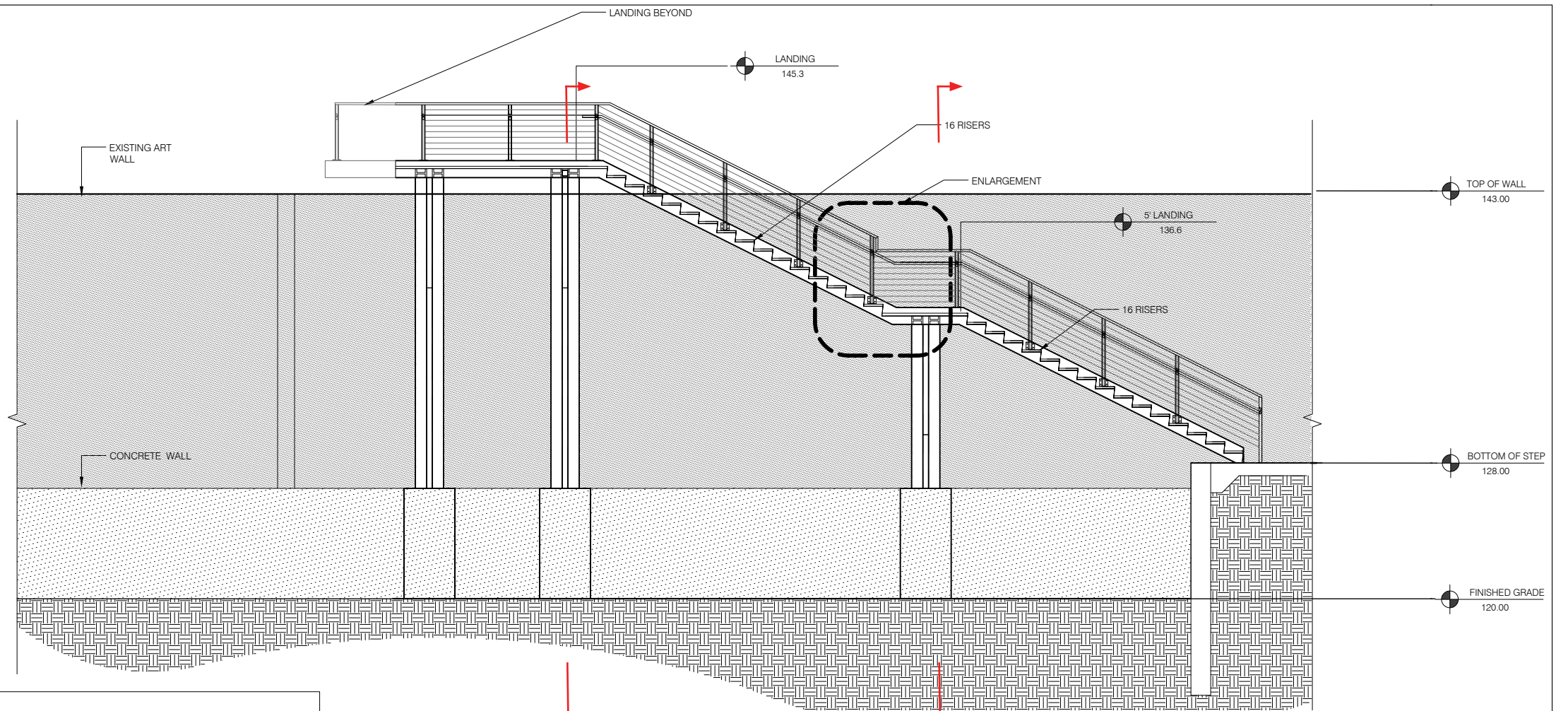

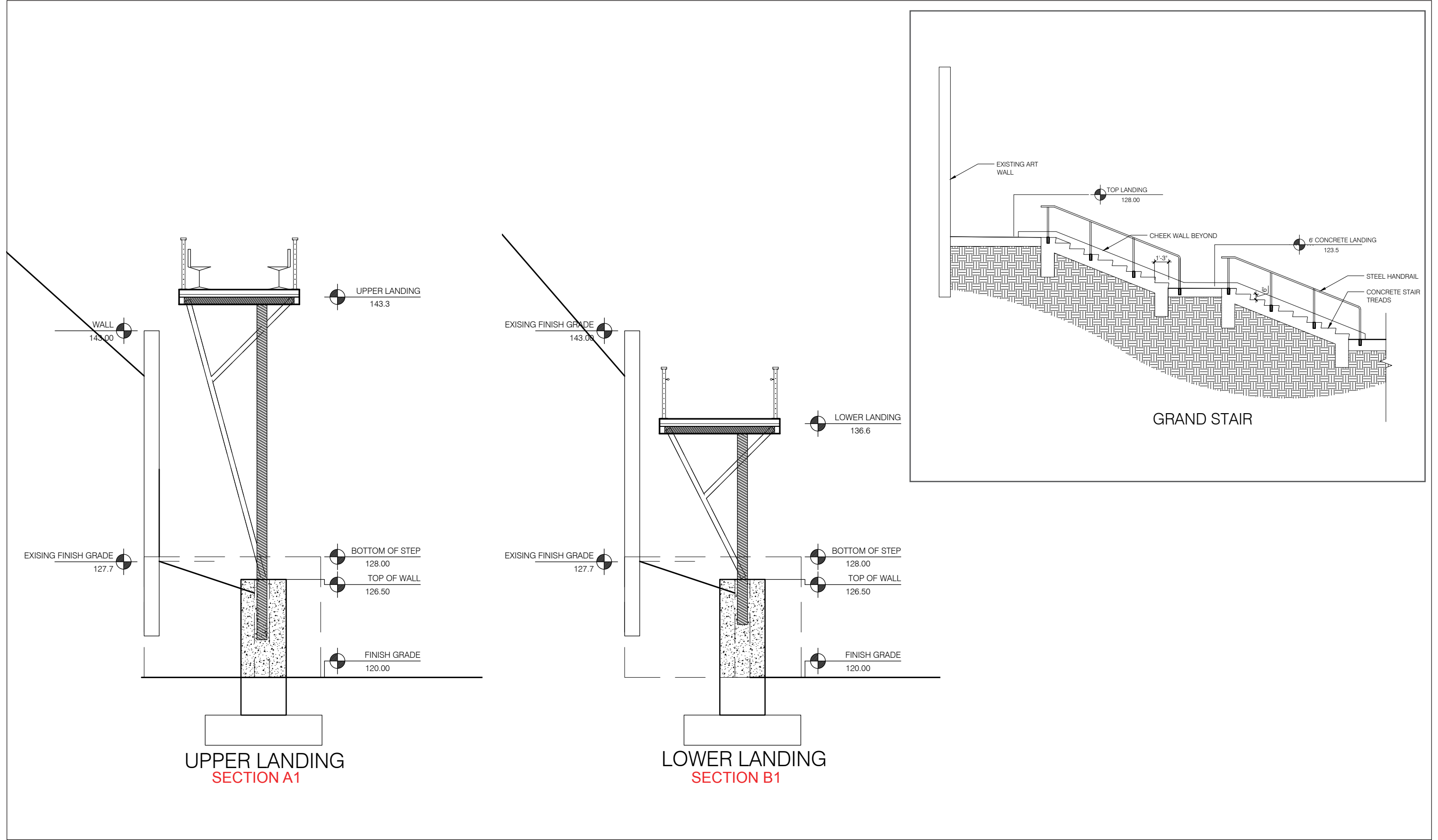



Note: Light Fixtures identified here are not exact representations of proposed site elements. These images are shown to provide general character of site features.



Catenary Lights



Pedestrian Scale Light Poles



Wall Up Lighting

- ① STREET LIGHT POLES
- ② CATENARY LIGHTS
- ③ UP LIGHTS AT ART WALL
- ④ PEDESTRIAN SCALE LIGHT POLES
(Represented for illustrative purposes only. Final Selection to be determined in Stage 2 submission)
- ⑤ MBT LIGHT FIXTURE
(Lights along MBT trail to remain as existing and relocated as necessary for trail realignment)



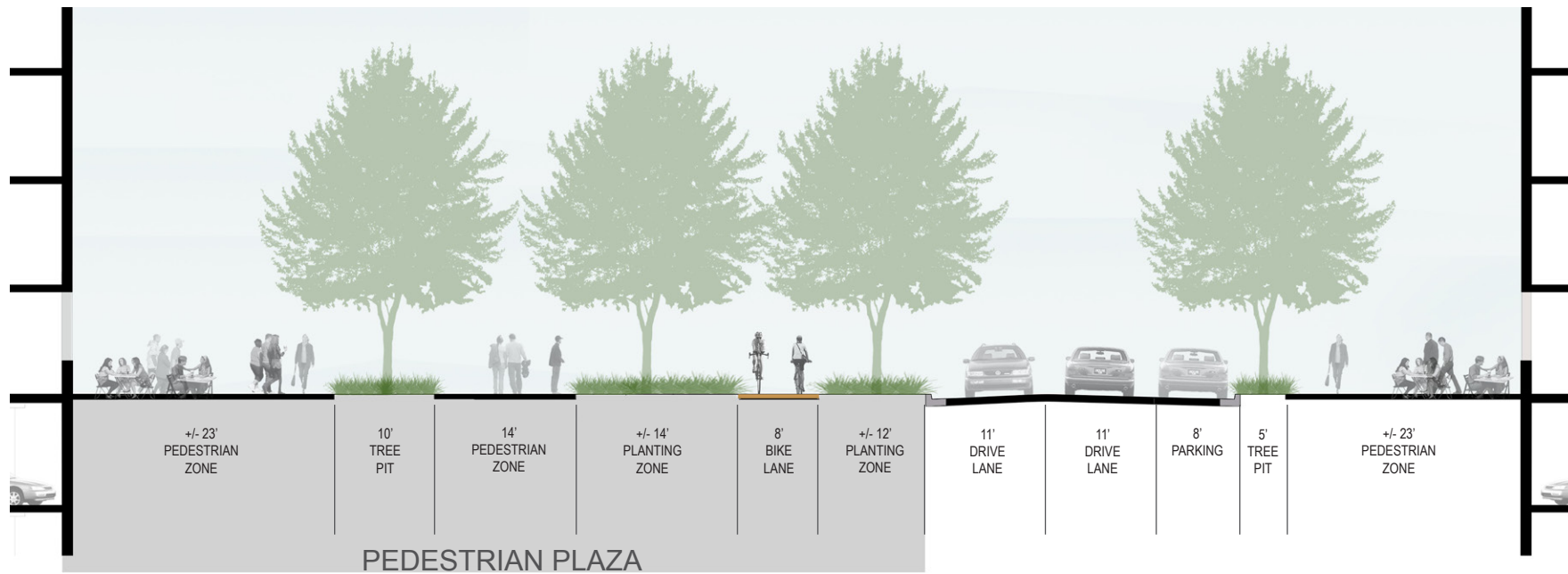

SECTION A

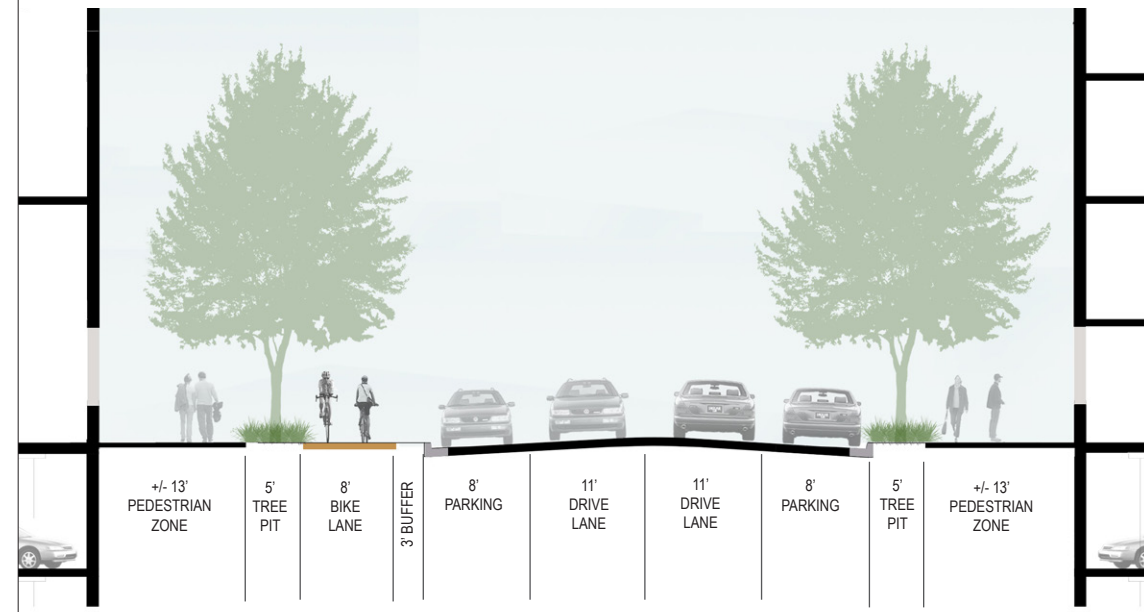

SECTION B

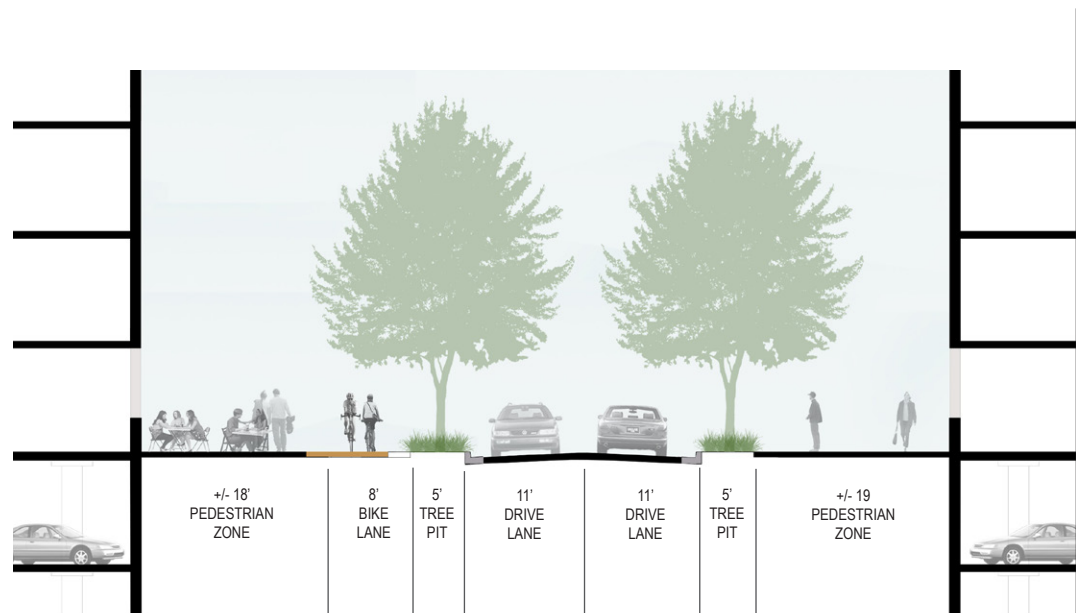

SECTION C

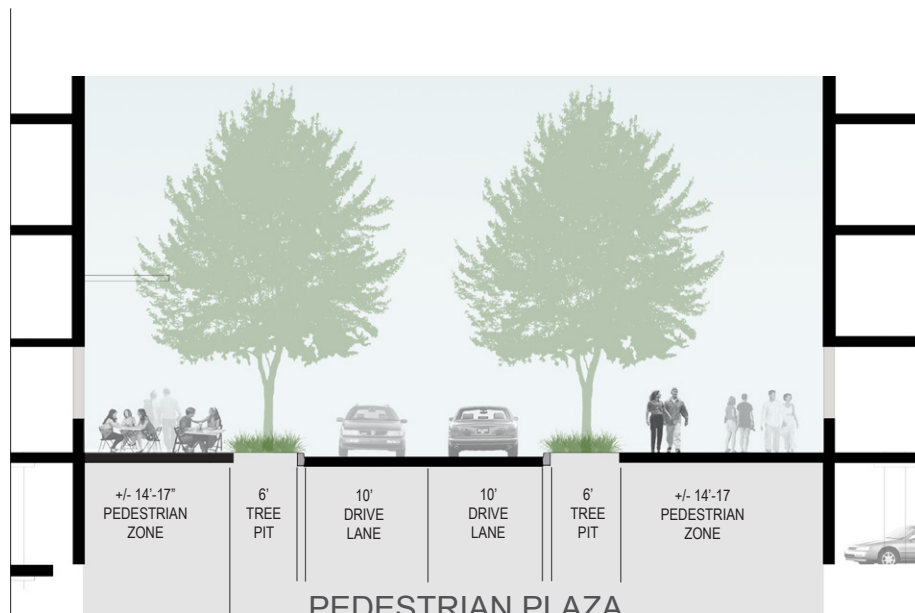

SECTION D

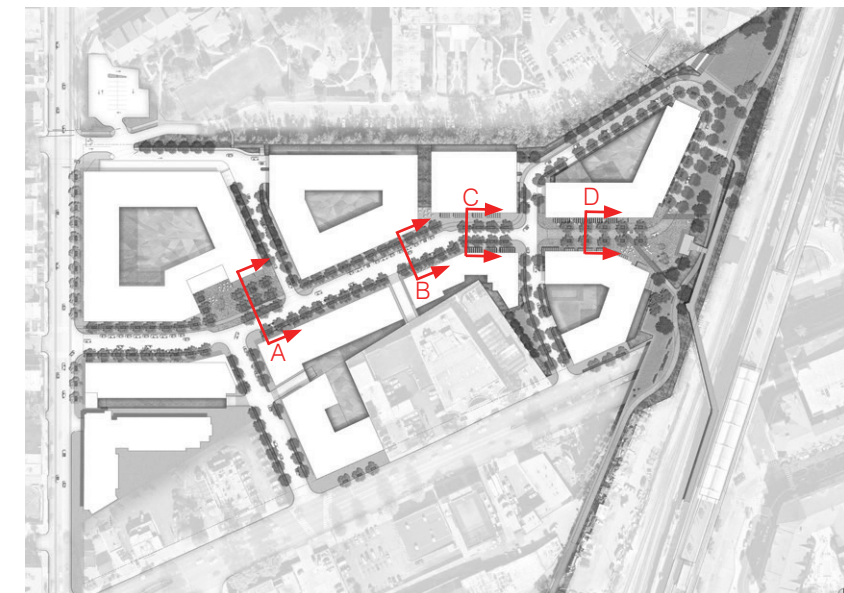

KEY PLAN

